

EN | ASSEMBLY INSTRUCTION

Eurovent® VENTOS X W35 roof vent

Eurovent® VENTOS X W35 roof vent is used as a roof exhaust for ventilation ducts in residential buildings and public utility buildings. It meets the requirements of modern construction, in accordance with standard PN-83/B-03430/Az3. It features an adjustable inclination angle from 5° to 45°, which facilitates installation on pitched roofs. A connection with a diameter of 150 mm guarantees free and stable airflow. The design of the cap supports natural draft by utilising wind force. It does not require additional insulation and is equipped with an anti-condensation system that effectively protects ventilation ducts against condensation and moisture.

W35 base plate: The roof vent is equipped with a base designed for installation on roofs covered with metal roof tiles with a W35 profile.

A: 325 mm B: 245 mm C: 181 mm D: ca. 142 mm H: ca. 35 mm

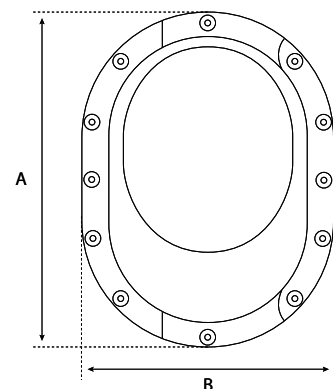
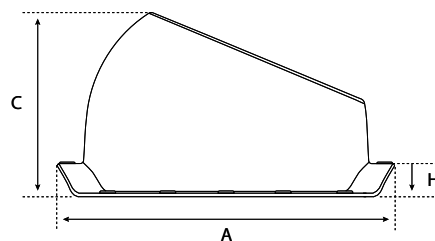
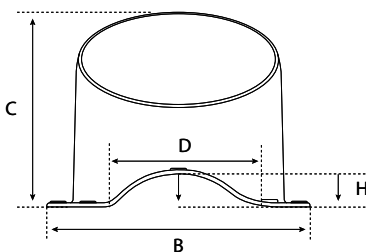

A: base length B: base width C: base height D: profile width H: profile height

Before installation: Ensure correct selection of the roof vent base model for the roof covering on which it will be installed. Installation of the roof vent is carried out directly onto the roof covering. For installation, use only the screws included in the set, the butyl adhesive integrated with the base, and, if necessary, additional butyl strips.

List of compatible roof coverings – page 2-3.

Installation instructions for the roof vent – pages 4-5.



Update date: 24/03/2026

EN | LIST OF ROOF COVERINGS

Compatible roof coverings list – Eurovent® VENTOS X W35.

The table presents verified and tested compatibility of the Eurovent® VENTOS X W35 roof vent base with metal roof tiles available on the market.

	Roof tile name	Roof tile manufacturer	VENTOS X base plate
A	AGA	LIMBLACH	W35
	AGAT	POLSTAL	W35
	AQUA	BLOK-BUD/BLOKBLACH/FINNOYA	W35
	ARIA	BUDMAT	W35
B	BARCELONA	DACHY ŁUCZAJ	W35
	BELLA	STALHART	W35
	BETA	POLSTAL	W35
C	CESAR	FINISH PROFILES	W35
D	DIANA	NOWAX	W35
	DUNA	ZEPART	W35
E	ECO OLIVIA	MAX SYSTEM	W35
	ELIOS	POLONICA	W35
	ELITA	BLACHSTAL	W35
	ENIGMA	BLACHOTRAPEZ	W35 + additional butyl
	EUROPA	FLORIAN CENTRUM	W35
F	FALA	WAT	W35
	FERRERA	BUDMAT	W35
	FIŃSKA	METALEX MIKOŁAJOWICE	W35
G	GALLA	GLINMET/WISTAL	W35
H	HONORATA	SOLAN	W35
J	JOWISZ	DACH-STYL	W35
K	KARA	UNIBLACH	W35
	KIARA	TRANSBLACH	W35
	KLARA	FLORIAN CENTRUM	W35
	KRISLINE	BLACHY WADOWSKI	W35
	KRON	PRUSZYŃSKI	W35
L	LENA	ZEPART	W35

Update date:24/03/2026

EN | LIST OF ROOF COVERINGS

	Roof tile name	Roof tile manufacturer	VENTOS X base plate
M	MAZOWSZANKA	KURPDACH	W35
	MEGA	LINDAB	W35
	MILO/MILO PLUS	TRANSTAL	W35
	MONZA	GLINMET/WISTAL	W35
N	NAREW	ATESTPOL	W35
	NORD	HANBUD	W35 + additional butyl
	NOVA	ROZBUD	W35
O	OLIMPIA	REGAMET	W35
	OLIVIA	MAX SYSTEM	W35
	OMEGA	BLACHPROFIL 2	W35
P	PAULA	DOM-BLACH	W35
	PERŁA/PERŁA PLUS	BLACHDOM PLUS	W35
	PODLASIE	BIALMET	W35
R	RZYMSKA	DACH-METAL	W35
S	SCANDIA	METALEX MIKOŁAJOWICE	W35
	SONATA	BLACHODACH	W35
T	TANGO	FINCO-STAL	W35
V	TOPAZ	WŁASTAL	W35
	VEGA	METALMIX	W35
W	WESTA	INTER-MAX	W35
Z	ZUZIA	MATPOL	W35

Scan the QR code

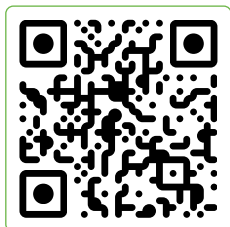

Find compatibility
with other bases
Eurovent® VENTOS X

Update date: 24/03/2026

EN | ASSEMBLY INSTRUCTION

Installation of the Eurovent® VENTOS X W35 roof vent – Metal roof tile.

1. Ensure a tight passage of the ventilation duct through the roof membrane.
2. Cut an opening for the ventilation duct at the location of the roof vent installation. If necessary, apply additional butyl strips at the profile location so that they connect with the roof vent base.
3. Remove the protective tape from the butyl adhesive on the underside of the roof vent base. Place the base at the location of the cut opening.
4. Fix the roof vent base using the screws included in the set.

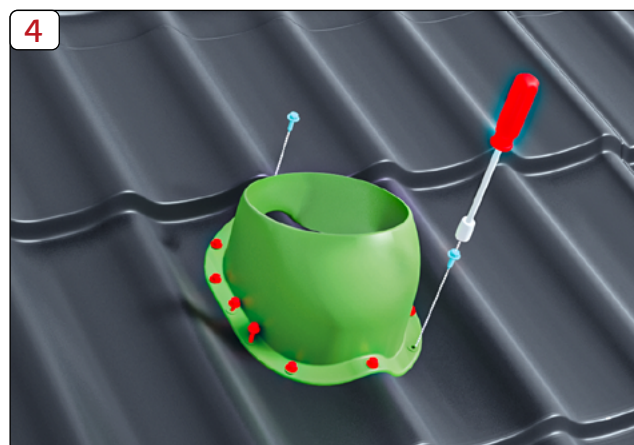
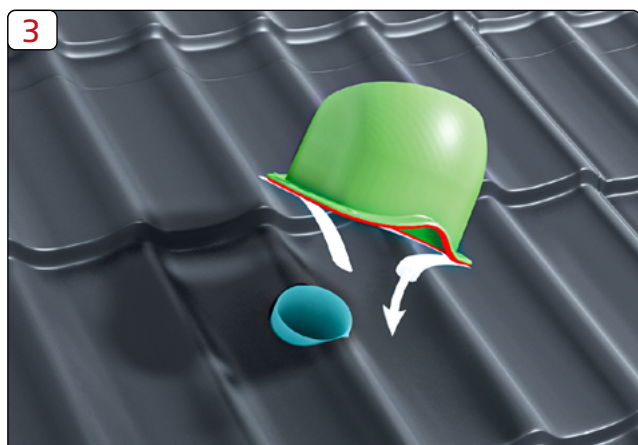
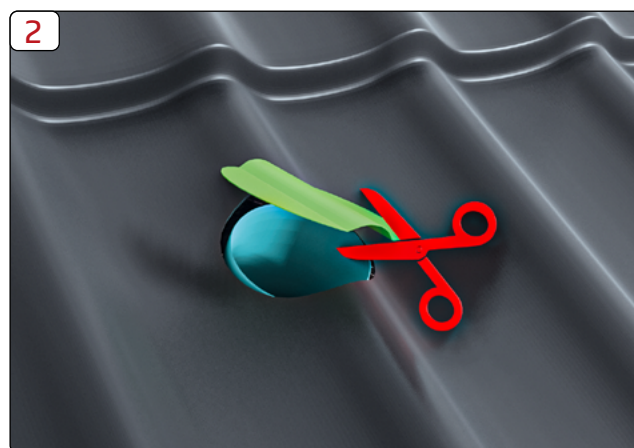

Update date:24/03/2026

EN | ASSEMBLY INSTRUCTION

5. Set the inclination angle of the roof vent.
6. Fix the roof vent to the base using the remaining screws included in the set.



Final information: The information, recommendations, and guidelines provided are based on our current best knowledge, research, and experience, and are given in good faith. We accept no liability for the consequences of improper or incorrect use of our products. Each user of this material should verify by all possible means, including testing the final product under appropriate conditions, the suitability of the supplied materials for achieving their intended objectives.

All installation works, maintenance, and technical inspections should be carried out exclusively by authorised, qualified, and experienced persons.

Update date: 24/03/2026