

EN | ASSEMBLY INSTRUCTION

Eurovent® VENTOS X PLUS C roof vent

The Eurovent® VENTOS X PLUS C roof vent is used as a roof exhaust for ventilation ducts in residential and public utility buildings. It meets the requirements of modern construction in accordance with PN-83/B-03430/Az3. It features an adjustable angle of inclination from 5° to 45°, which facilitates installation on pitched roofs. A connection with a diameter of 150 mm ensures free and stable airflow. The design of the cap supports natural draft by utilising wind force. It does not require additional insulation and is equipped with an anti-condensation system that effectively protects ventilation ducts against condensation and moisture.

PLUS C base plate: The roof vent is equipped with a base designed for installation on pitched roofs covered with "C" type Celtycka concrete roof tiles.

A: 420 mm B: 330 mm C: 197 mm H: 52 mm

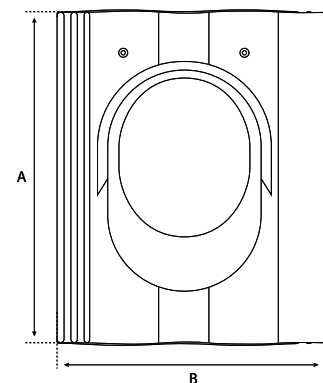
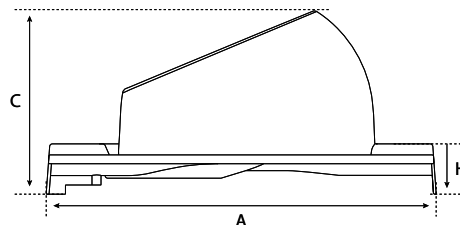
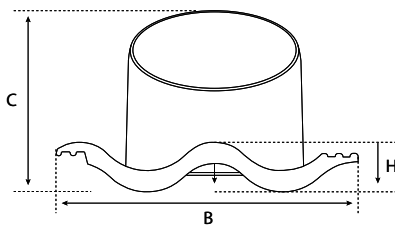

A: base length B: base width C: base height H: embossing height

Before installation: Make sure that the correct model of the roof vent base is selected for the roof covering on which it will be installed. The roof vent base replaces the roof tile at the installation location. The installation of the roof vent base is carried out to the structural batten. Only the screws included in the set should be used for installation. Recommended installation temperature of the roof vent: from 5°C to 40°C.

List of compatible roof coverings – page 2.

Installation instructions for the roof vent – pages 3–4.



Update date: 24/03/2026

EN | LIST OF ROOF COVERINGS

List of compatible roof coverings – Eurovent® VENTOS X PLUS C.

The table presents verified and tested compatibility of the Eurovent® VENTOS X PLUS C roof vent base with concrete roof tile models available on the market.

	Roof tile name	Roof tile manufacturer	VENTOS X base plate
C	CELTYCKA	BRAAS	PLUS C
P	PALEMA	BENDERS	PLUS C
S	SIGMA	NELSKAMP	PLUS C

Scan the QR code



Find compatibility
with other bases
Eurovent® VENTOS X

Update date: 24/03/2026

EN I ASSEMBLY INSTRUCTION

Installation of the Eurovent[®] VENTOS X PLUS C roof vent – concrete roof tile.

Recommended installation temperature: from 5°C to 40°C

1. Remove the roof tiles at the installation location of the roof vent.
2. Make an airtight penetration of the ventilation duct through the roof membrane.
3. Place the base at the installation location of the roof vent. Fix the roof vent base and fasten it to the structural batten using two wood screws.
4. Install the roof tiles around the fixed roof vent base.

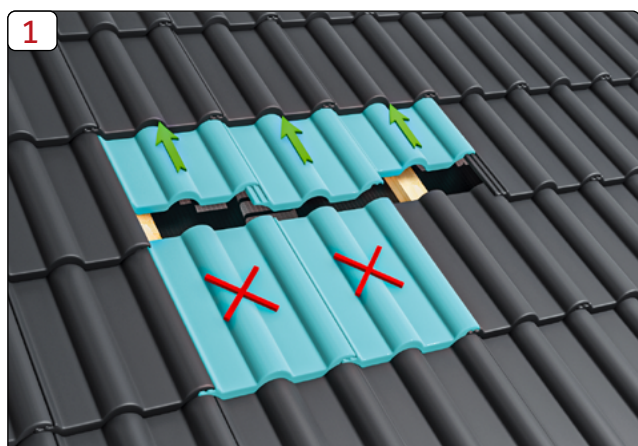

Update date: 24/03/2026

EN | ASSEMBLY INSTRUCTION

5. Adjust the angle of inclination of the roof vent.
6. Fix the roof vent to the base using the remaining screws included in the set.

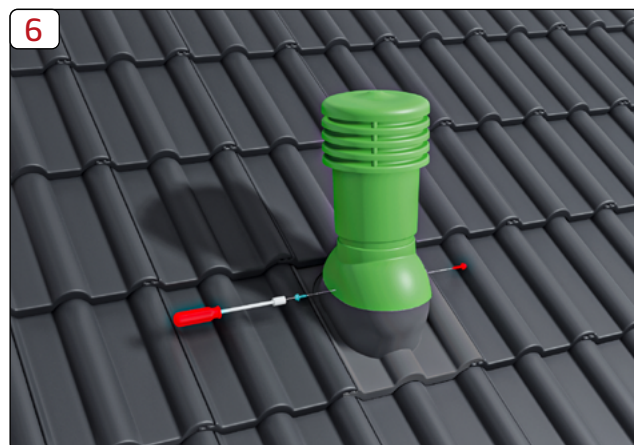

Final information: The information, recommendations and guidelines provided are based on our current best knowledge, research and experience, and are given in good faith. We do not accept liability for the consequences of improper or incorrect use of our products. Each user of this material should verify by all possible means, including testing the final product under appropriate conditions, the suitability of the supplied materials for achieving their intended purposes.

All installation works, maintenance and technical inspections should be carried out exclusively by authorised, qualified and experienced personnel.

Update date: 24/03/2026