

EN | ASSEMBLY INSTRUCTION

Eurovent® VENTOS X F22 roof vent

The Eurovent® VENTOS X F22 roof vent is used as a roof exhaust for ventilation ducts in residential and public buildings. It meets the requirements of modern construction in accordance with the PN-83/B-03430/Az3 standard. It features an adjustable inclination angle from 5° to 45°, which facilitates installation on pitched roofs. A connection with a diameter of 150 mm ensures free and stable airflow. The cowl structure supports natural draft by utilising wind force. It does not require additional insulation and is equipped with an anti-condensation system that effectively protects ventilation ducts against condensation and moisture.

F22 base plate: The roof vent is equipped with a base adapted for installation on roofs covered with metal roof tiles with an F22 profile.

A: 325 mm B: 245 mm C: 180 mm D: ca. 143 mm H: ca. 25 mm

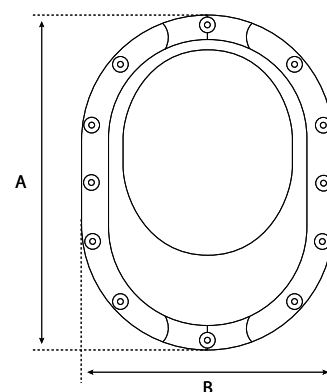
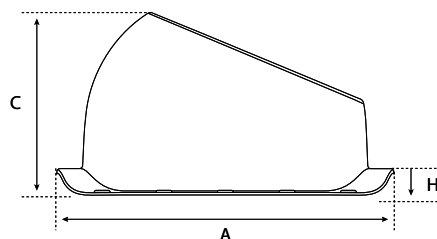
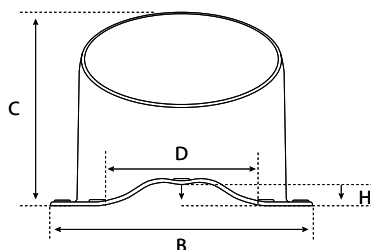

A: base length B: base width C: base height D: embossing width H: embossing height

Before installation: Ensure the correct selection of the roof vent base model for the roof covering on which it is to be installed. Installation of the roof vent is carried out directly onto the roof covering. For installation, use only the screws included in the set, the butyl adhesive integrated with the base, and, if necessary, additional butyl strips.

List of compatible roof coverings – page 2.

Installation instructions for the roof vent – pages 3–4.



Update date: 25/03/2026

EN | LIST OF ROOF COVERINGS

List of compatible roof coverings – Eurovent® VENTOS X F22.

The table presents verified and tested compatibility of the Eurovent® VENTOS X F22 roof vent base with metal roof tiles available on the market.

	Roof tile name	Roof tile manufacturer	VENTOS X base plate
A	AMALFI PLUS	BLACHDOM PLUS	F22
	ARMANO	DACHY ŁUCZAJ	F22
	ASTRA	POLONICA	F22
	AURORA	BRATEX	F22
B	BLIZZARD	SOLID STEEL /BLACHOTRAPEZ	F22
F	FAMILIA	STAHLBERG	F22
	FINLANDIA/FINLANDIA DE LUX	BLACH-POL	F22
	FINNERA	RUUKKI	F22
B	FLAMENCO	BLACHODACH	F22
	FLEX	PLANNJA	F22
G	GAMMA 25	BLACHPROFIL 2	F22
	GAMMA 35	BLACHPROFIL 2	F22
	GERMAN	BLACHOTRAPEZ	F22
	GRANDE	STAHLBERG	F22
	GRYF	PRUSZYŃSKI	F22
H	HERKULES	BLACHSTAL	F22
K	KARAMZYN	TRANSTAL	F22
	KARPATIA	DACH-STYL	F22
L	LARGO PANEL/LARGO CLASSIC	FINCO STAL	F22
	LIDIA	FLORIAN CENTRUM	F22
	LOARA	PRUSZYŃSKI	F22
M	MALTA	HANBUD	F22
	MARY STEEL/MARY STEEL L	FINISH PROFILES	F22
	MAXIMA	REGAMET	F22
	METRUM	FINCO-STAL	F22
	MODERNO	HANBUD	F22
	MODUŁOWA	ROZBUD	F22
	MONA/MONA DUO	REGAMET	F22
N	NORDICA+/NORDICA PANEL	BLACHY MINDA	F22
O	ONYX	BLACHY ZIEMIŃSKI	F22

Update date:25/03/2026

EN | LIST OF ROOF COVERINGS

	Roof tile name	Roof tile manufacturer	VENTOS X base plate
P	PANORAMA	BALEXMETAL	F22
	POLA	POLSTAL	F22
	PRESTIGE	STAHLBERG	F22
S	SCANDINAVIA	BRATEX	F22
	SIÓDEMKA	DACHPOL WŁOSZCZOWA	F22
	SOLIS	BLOK-BUD/BLOKBLACH/FINNOYA	F22
	STIGMA 2.0	BLACHPROFIL2	F22
	SYMETRIA	BLACH-POL	F22
	SYMETRIA DE LUX	BLACH-POL	F22
T	TAMARA	FLORIAN CENTRUM	F22
	TUR	PRUSZYŃSKI	F22
V	WENECA	BUDMAT	F22
Z	ZET	BLACHPROFIL 2	F22

Scan the QR code

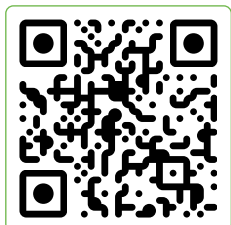

Find compatibility
with other bases
Eurovent® VENTOS X

Update date: 25/03/2026

EN | ASSEMBLY INSTRUCTION

Installation of the Eurovent[®] VENTOS X F22 roof vent – metal roof tile.

1. Ensure a tight penetration of the ventilation duct through the roof membrane.
2. Cut an opening for the ventilation duct at the installation location of the roof vent.
3. Remove the protective tape from the butyl adhesive on the underside of the roof vent base. Place the base in the location of the cut opening.
4. Fix the base of the roof vent using the screws included in the set.

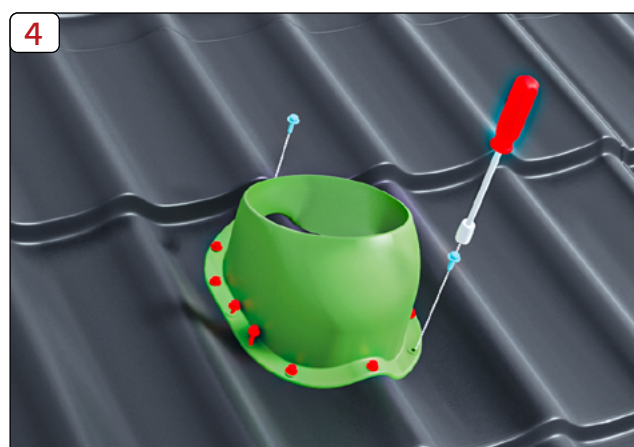
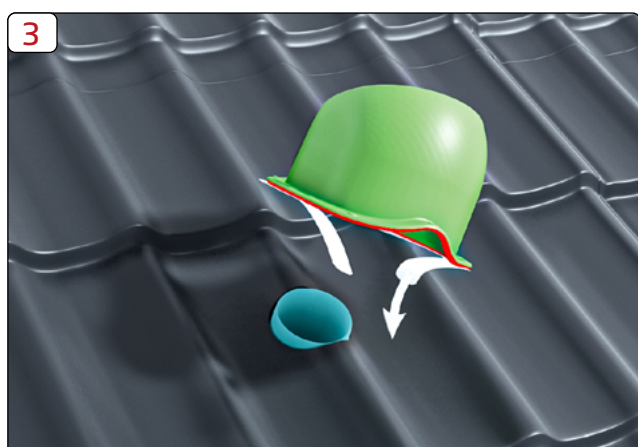
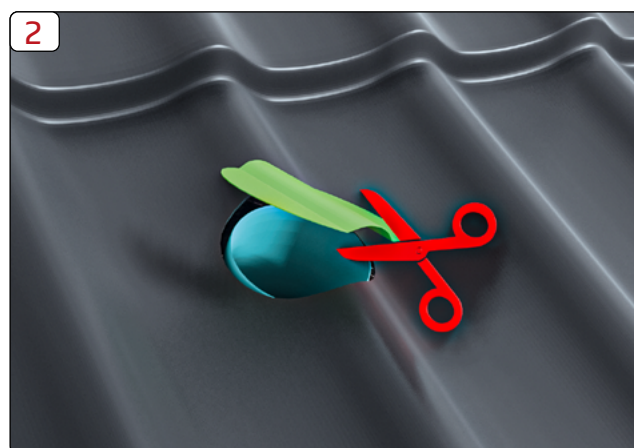

Update date: 25/03/2026

EN | ASSEMBLY INSTRUCTION

5. Adjust the inclination angle of the roof vent.
6. Fix the roof vent to the base using the remaining screws included in the set.



Final information: The information, recommendations and guidelines provided are based on our current best knowledge, research and experience, and have been given in good faith. We accept no liability for the consequences of improper or incorrect use of our products. Each user of this material should verify by all possible means, including testing the final product under appropriate conditions, the suitability of the supplied materials for achieving their intended purposes.

All installation, maintenance and technical inspection works should be carried out exclusively by authorised, qualified and experienced personnel.

Update date: 25/03/2026